

PRINT



WASH



CURE

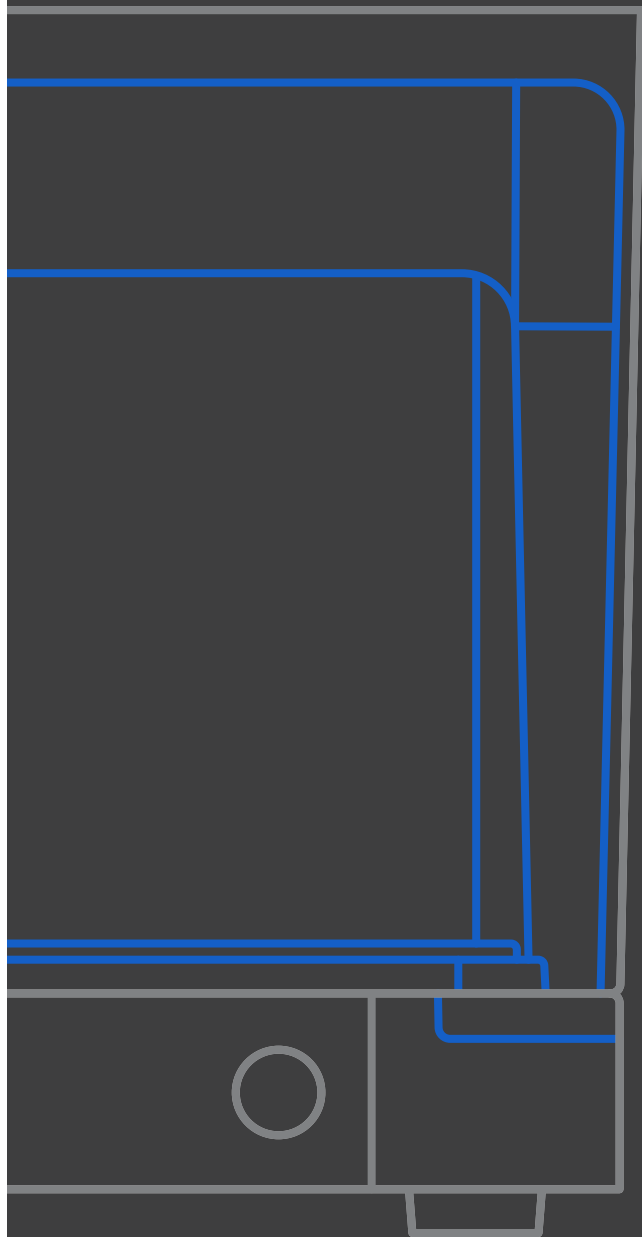

Form Cure

FORM CURE SYSTEM OVERVIEW

Form Cure provides the light and heat necessary to post-cure 3D printed parts to their optimal properties.

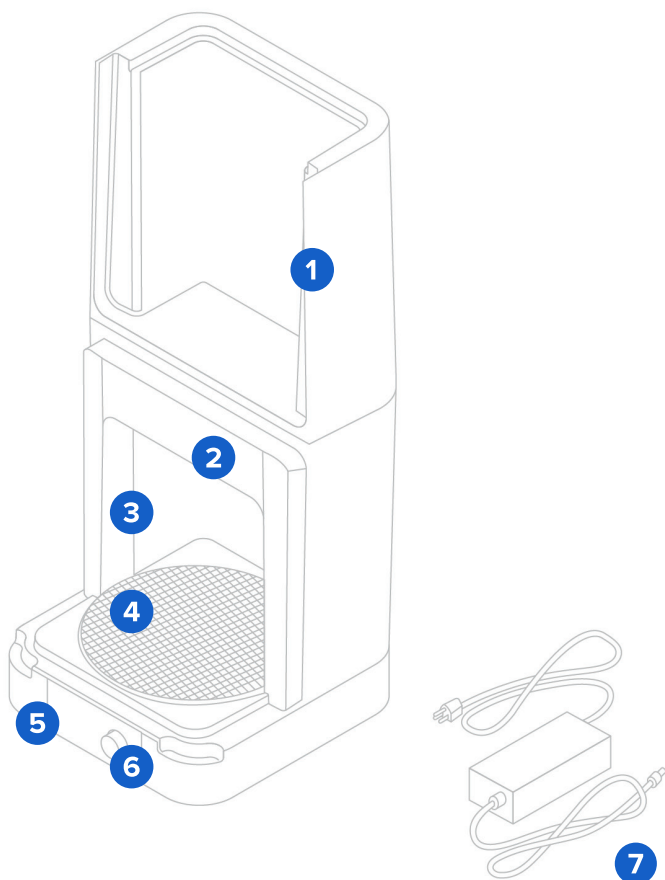

- 1 Cover.** Double walls insulate the cure chamber and internal surfaces reflect light.
- 2 Heater.** A 100W heating module can heat the chamber up to 176 °F/80 °C.
- 3 LEDs.** An array of 405 nm LEDs help to post-cure parts.
- 4 Turntable.** The rotating plate ensures balanced post-curing across all exposed surfaces.
- 5 Display.** Shows status, time, temperature, and options for configuring Form Cure.
- 6 Knob.** Turn or push to adjust time and temperature settings and to start, pause, or stop post-curing.
- 7 Power Supply.** Provides power to Form Cure. *Specifications: 24 V, 6 A*

USING FORM CURE

1. Connect Power Supply

Connect the power cable to Form Cure and a power source.

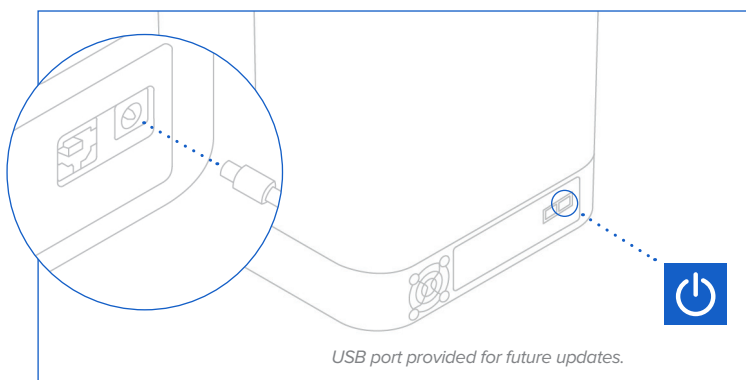

2. Insert Washed and Dried Prints

Before post-curing, allow at least 30 minutes for isopropyl alcohol (IPA) to fully evaporate after washing. Check all surfaces; post-curing non-dried parts may affect quality. Once parts are dry, lift the cover, then distribute parts on the round turntable and gently close the cover.

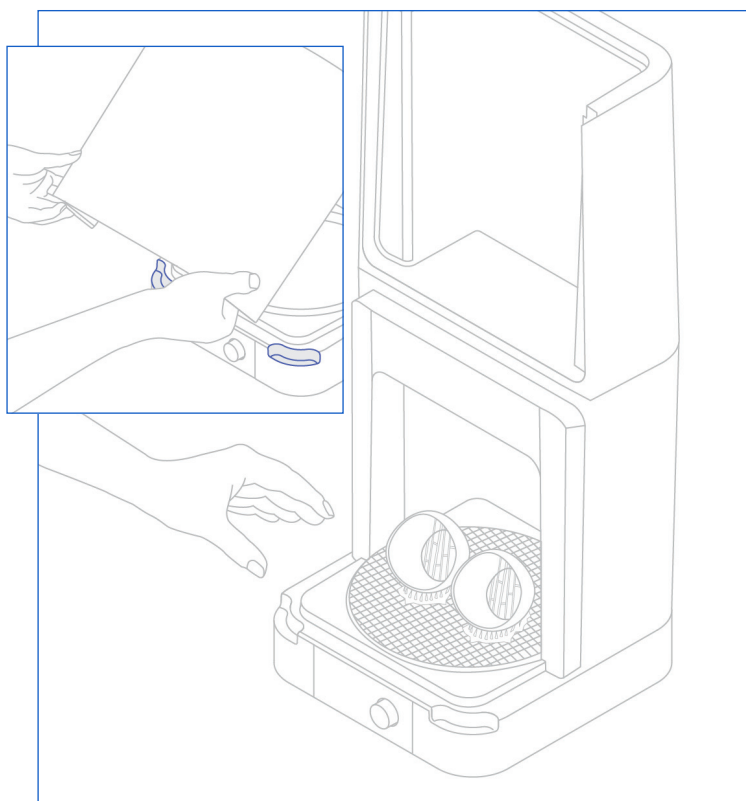

USING FORM CURE

3. Set Cure Time and Temperature

Turn the knob to navigate the display menu. Press the knob to select a feature or setting. Select the time and temperature, then select “Start.” The LEDs will activate once the heater has reached the target temperature. Once a cure cycle has started, use the display or open the cover to pause.

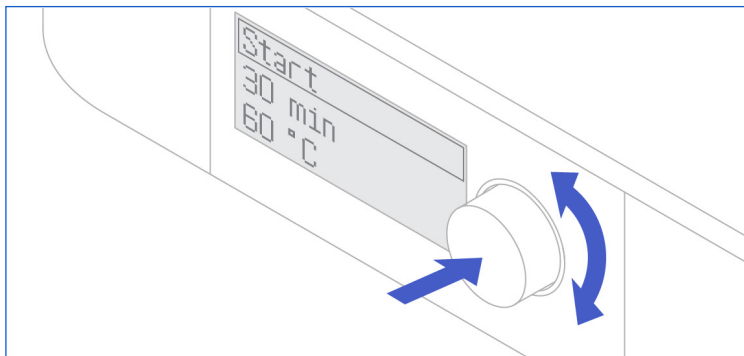

POST-CURE SETTINGS

For Standard Resins use default post-cure settings of 60 °C for 30 minutes.

Proper post-curing requires light and heat. All materials have unique time and temperature settings for optimal material properties. Use the space below to note the recommended settings from formlabs.com/cure-support.

POST-CURE NOTES

4. Collect Prints

When the cure cycle completes, the LEDs and heater will turn off. Lift the cover to remove the parts.

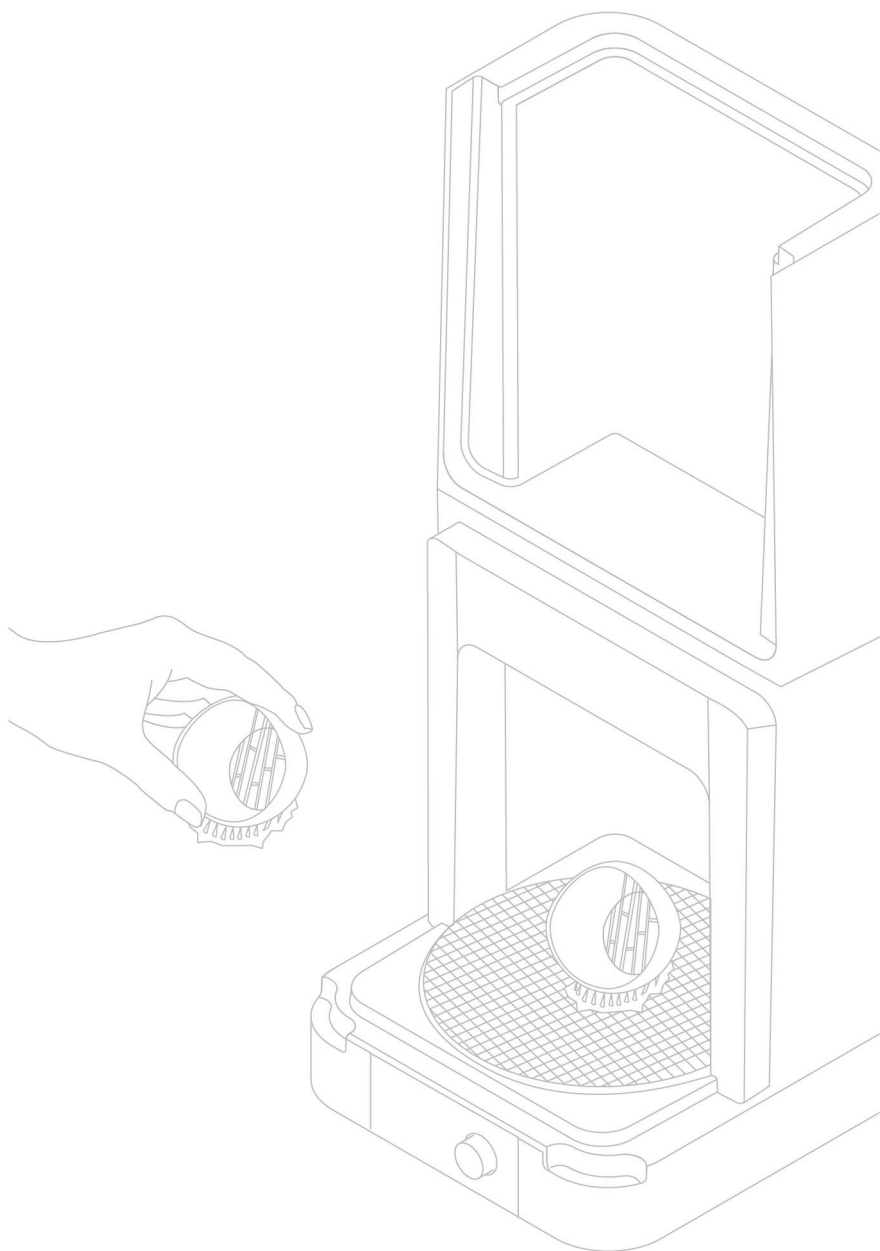

ADDITIONAL RESOURCES

Safety

For complete information, see the included **Safety Guide**. The Form Cure contains a heater to enable post-curing. Take care when removing parts from the Form Cure. The metal turntable may be hot.

Best Practices

POST-CURE SETTINGS

For Standard Resins, use default post-cure settings of 60 °C for 30 minutes. All other materials have unique recommended settings for optimal material properties. Check for recommendations at formlabs.com/cure-support.

MAINTENANCE

Periodically lift the turntable to inspect for small pieces of cured resin. Clean the turntable and the surface underneath as needed. Isopropyl alcohol (IPA) is suitable to clean most surfaces. Use a non-abrasive cloth on the reflective walls.

AFTER POST-CURING PRINTS

After washing, drying, and post-curing prints, consider adding other steps to your printing workflow. Use sanding, priming, or painting to improve presentation, or use other equipment to create molds from printed parts.

Additional Supplies

Powder-free disposable gloves

Sandpaper

Mineral oil

Primer and paints

More Information

Video tutorials and more instructions: support.formlabs.com

Post-curing recommendations: formlabs.com/cure-support

Formlabs Inc.

35 Medford St. Suite 201 | Somerville, MA 02143 | USA

Original Instructions

Keep this manual for future reference.



This product complies with the requirements of the Electromagnetic Compatibility Directive as defined in 2014/30/EU and Low Voltage Directive 2014/35/EC.

This guide is available in other languages on support.formlabs.com.

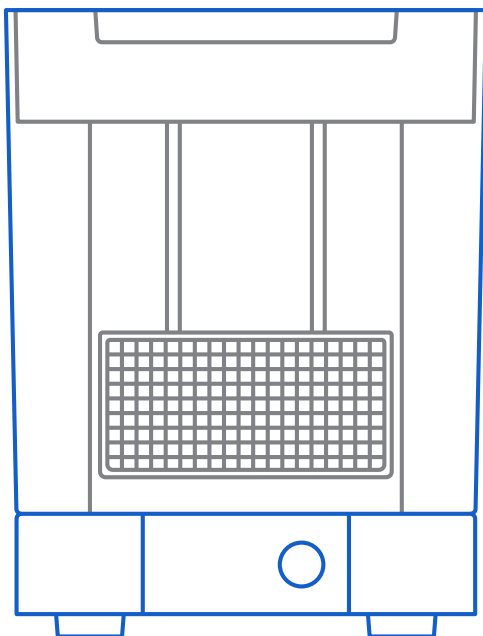

Form Wash

A Complete System For Cleaner, Stronger Parts

Form Cure

